



2024 PRACTICAL INFORMATION

PUMARINRI.COM



General tips



INSECTS

Good news: at Pumarinri, there are no mosquitoes, so we don't use mosquito nets.

At some times of the year, there are biting flies, so it is advisable to use repellent (we have them for sale at reception) or pants and long-sleeved shirts outdoors.

If you want to ventilate the room and open doors or screens at night, it is advisable to turn off the lights, or you will have moths attracted to the light. They do not sting, but they can be annoying at bedtime.

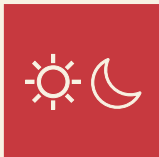

THE JUNGLE WAKES UP EARLY

First thing in the morning is when many animals, especially birds, are most active. At that time, you will have more possibilities to observe a greater number of species. As the temperature rises, the activity in the jungle decreases.

In the same way, it is more pleasant to walk in the morning, avoiding the central hours of the day, in which we can enjoy the pool or rest in the shade. For this reason, most of our tours and activities are scheduled in the morning.



TOURS ON TIME

We like to respect the tour schedules. We also want to respect the rest of our guests. If you prefer to rest, we do not call the rooms at the time of departure of the tours.

If you are not present at the departure time of a contracted tour, it is considered a No Show and does not entitle you to a refund, compensation or rescheduling of the tour.



SAFETY RECOMMENDATIONS

The rooms of the Pumarinri are traditionally built with local materials such as palm and wood roofs. Smoking is not allowed in them, nor is it allowed to light candles or incense.

It is important to wear the appropriate footwear and clothing on tours and excursions. In addition, inform yourself before each outing about other items that may be useful to you.

We are in the tropics. Solar radiation is intense, and we must protect ourselves from it if we are exposed to the sun for a long time. It is important that we rehydrate when it is hot or when we lose water through perspiration on walks.

More and more 'reality shows' are proliferating on television where a seasoned explorer explains to us the number of dangers that lie in wait for him on his adventures through the jungle, but in truth, there is more 'show' than 'reality' in them. The incidents are very unusual, even more so if we keep our eyes open and have an attitude of respect towards nature.



PETS

We are in a natural space, so the presence of pets in the lodge is restricted. If you want to bring your pet, see the conditions that apply at www.pumarinri.com/politica-de-mascotas/



FIRST AID KIT AND MEDICAL SERVICES

The lodge has a first aid kit. However, by law, we cannot provide general or specific medicines.

Connectivity and electronic devices



Connectivity and electronic devices



INTERNET

The Pumarinri has Wi-Fi. This service is free.

Being in an isolated area between mountains, to bring the internet signal to the lodge, we use a complex system of repeater antennas on the hills between Tarapoto and Pumarinri. The speed and **capacity of the Wi-Fi that we offer is the best that can be achieved** in these conditions. It allows the use of e-mail, social networks and browsing, among others. However, for someone considering taking advantage of the holidays **to watch their favourite Netflix series, the Pumarinri is probably not the ideal destination.**

The internet connection is subject to inclement weather, such as torrential rain and wind, and other elements that may affect its operation. Our internet usually operates in a stable and regular way, but on specific occasions, it can be interrupted or slowed down by factors such as those mentioned, and its replacement may take a few hours. In case of lightning or major damage, it can be extended to more than one day.

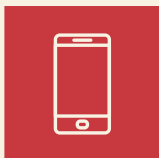

CELL PHONE

At Pumarinri there **is no cell coverage**. However, in the neighbouring towns of Shapaja and Chasuta there is a signal from Bitel, Claro and Movistar.



PLAYING AUDIO AND USE OF HEADPHONES

Pumarinri is not just a place of rest and relaxation; we also like to listen to the sounds of nature. For this reason, playing music or audio is not allowed in the hotel's public areas at any volume.

With headphones, you can enjoy music or videos without affecting the rest of the guests.



USE OF DRONES

For privacy reasons and not to interfere with local birds and fauna, drones at Pumarinri are regulated. If you wish to use a drone in our facilities, you must request authorization from info@pumarinri.com a minimum of 48 hours in advance.

Lodge services 

Lodge services



RESTAURANT

Pumarinri's menu blends food from the Peruvian jungle with international food.

We have vegetarian options. If you have any questions about the ingredients of a particular dish, please ask our restaurant staff.

Restaurant hours are:

Breakfast: 7 a.m. to 10 a.m.

Lunch: 1 to 3 p.m.

Dinner: 7:00 to 9:00 p.m.

Additionally, a snack menu is available for orders from 3 p.m. to 6 p.m.

Wine and spirits have a corkage fee if consumed in the restaurant or on the pool terraces. Other types of drinks are not allowed in the restaurant or pool if they have not been purchased at the hotel.

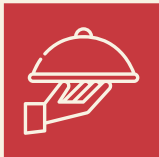

ROOM SERVICES

Room service is available from 10 a.m. to 9 p.m. with an additional charge of 10%.

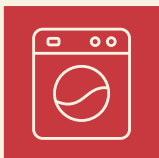

LAUNDRY

We have laundry service. The rates and times of collection and delivery are shown on the control sheet that you will find in the closet of your room.



LIBRARY AND BOOK EXCHANGE

The library is in reception and has a selection of books on Amazonian nature, biodiversity, flora and fauna, its people and culture and other aspects of our jungle.

Next to the library, there is a Book Exchange, which allows the exchange of books under the 'leave one, take one' policy.



TRANSPORTATION TO TARAPOTO & AIRPORT

We have modern and comfortable vehicles equipped with air conditioning for transfers to Tarapoto or other connections. Our drivers have extensive experience on the routes in the area.

There are established daily departure times from/to Tarapoto, and services can also be contracted privately. Consult reception or reservations for more information. We recommend making the reservation of transfers a minimum of 24 hours in advance.

We discourage using motorcycles (mototaxis) for road transfers to Tarapoto or other places due to the danger involved in using these vehicles outside the urban centre.



EVENTS AND MEETINGS

We have a tambo or maloca, a traditional jungle construction with a capacity for up to 50 people (according to availability) with views of the Huallaga River.

Please consult the reception or our reservations department if you want to hire it for a social or work event.









MASSAGES

Request it 24 hours in advance, and we will schedule a time for the service.

Swimming at Pumarinri →

PUMARINRI Lodge

LEYENDA

-  RUTA DEL CACAO
-  RUTA DE LA COCA
-  RUTA DEL HUALLAGA
-  RUTA DE LAS RANAS DARDO
-  RUTA DE LOS BUHOS
-  RUTA QUEBRADA YURACYAQUILLO

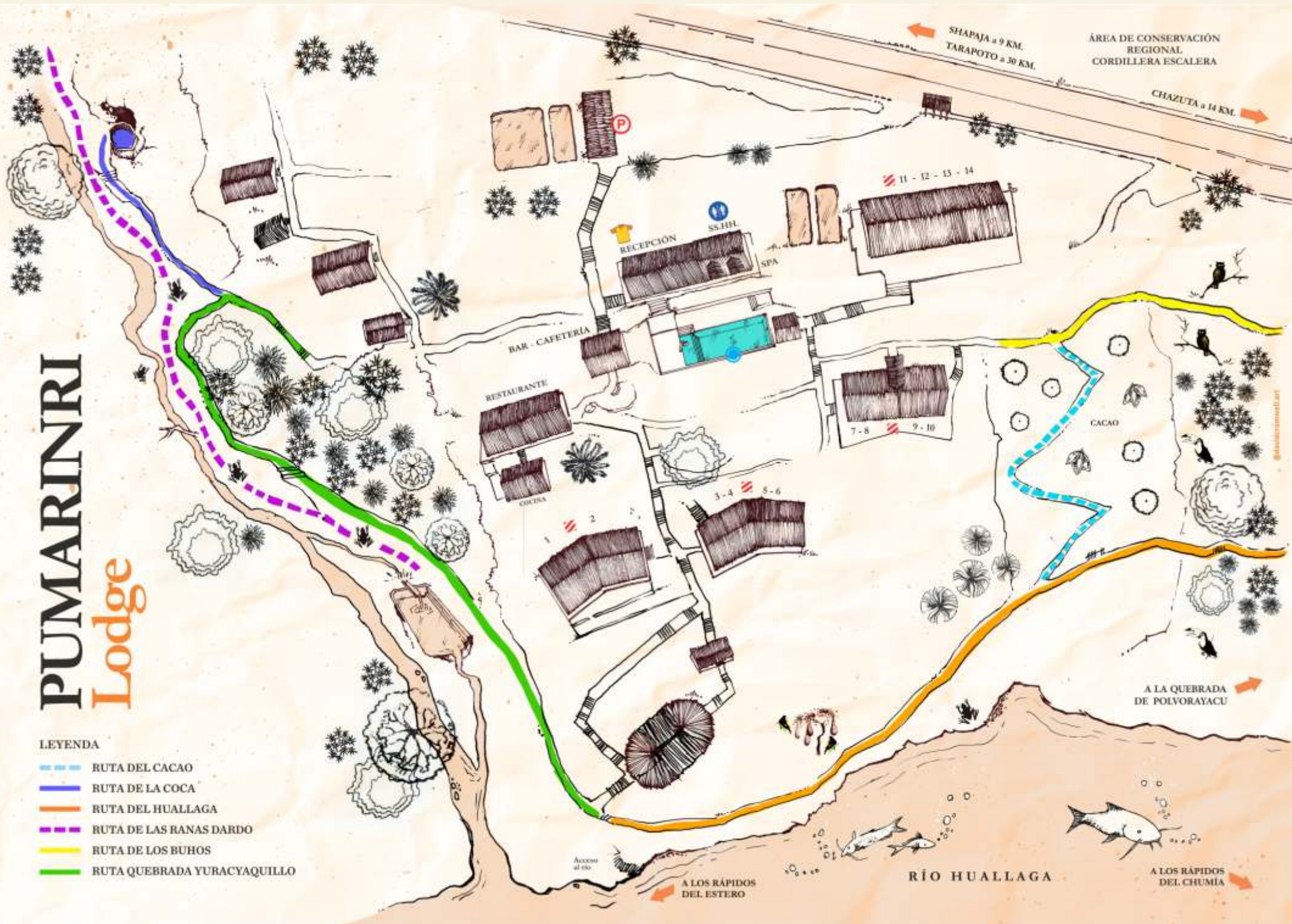

ÁREA DE CONSERVACIÓN REGIONAL CORDILLERA ESCALERA

SHAPAJA a 9 KM.
TARAPOTO a 30 KM.

CHAZUTA a 14 KM.

RECEPCIÓN
SS.HH.
SPA

BAR - CAFETERIA

RESTAURANTE

COCINA

CACAO

RÍO HUALLAGA

A LOS RÁPIDOS DEL ESTERO

A LA QUEBRADA DE POLVORAYACU

A LOS RÁPIDOS DEL CHUMIA

www.pumarinri.com

ÁREA DE CONSERVACIÓN
REGIONAL
CORDILLERA ESCALERA

SHAPAJA a 9 KM.
TARAPOTO a 30 KM.

CHAZUTA a 14 KM.

PUMARINRI

Canopy Penthouses

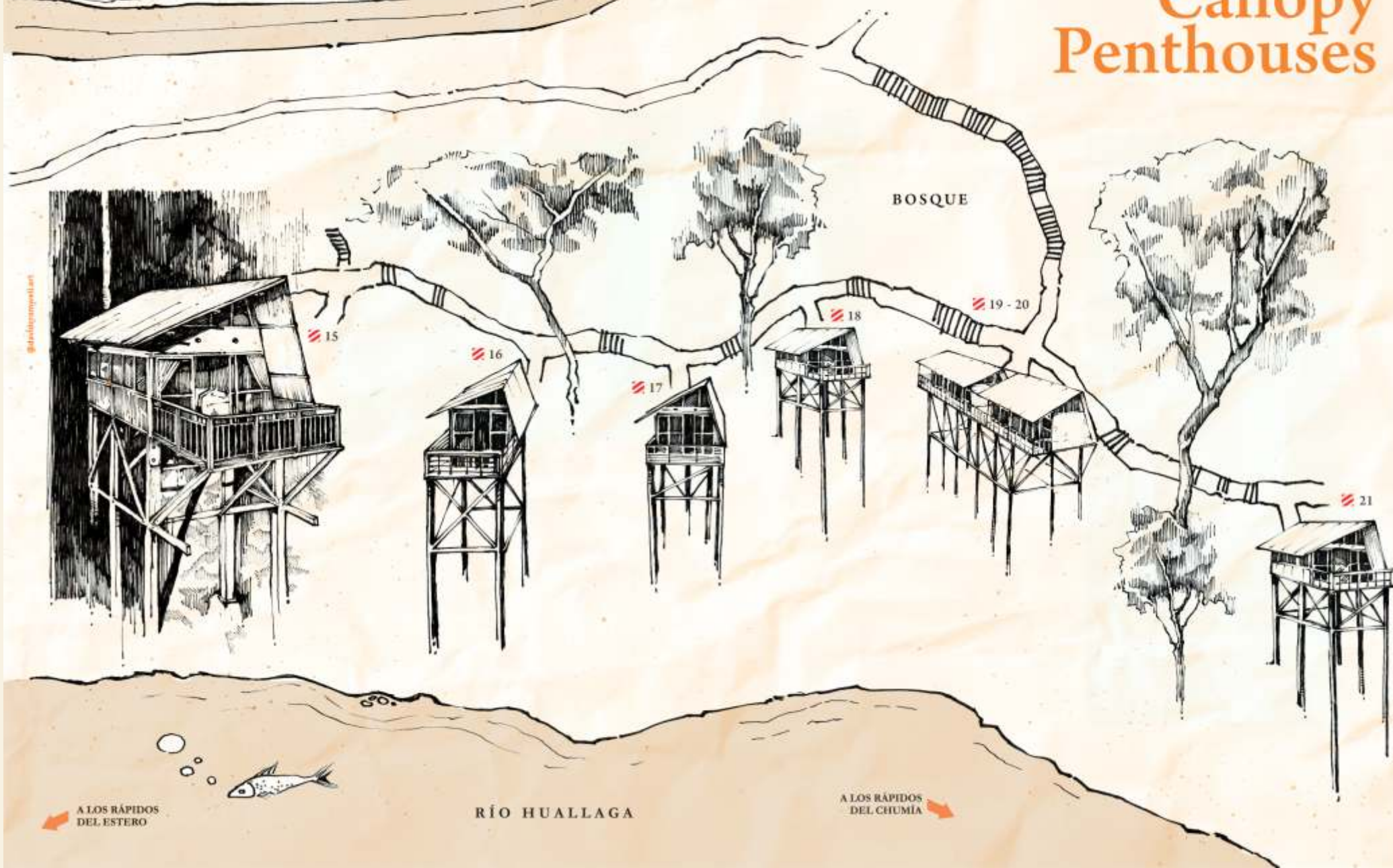

patrolcampesino

BOSQUE

15

16

17

18

19 - 20

21

A LOS RÁPIDOS
DEL ESTERO

RÍO HUALLAGA

A LOS RÁPIDOS
DEL CHUMIA

Swimming at Pumarinri



POOL

Pool hours are from 9 a.m. to 9 p.m.

The pool does **not have a lifeguard**, so using it is **your responsibility**. Next to the pool, you will find a sign with the rules of use.

POOL IN THE YURACYAQUILLO STREAM

In the Yuracyaquillo ravine, there is a natural pool for bathing in its refreshing waters in an environment of vegetation and nature.

Bathing in this pool is the **responsibility of the user**. Please read the sign with the rules and recommendations that is there.

BATH IN THE HUALLAGA

The Huallaga River is **extremely mighty**, and as it passes through the Pumarinri, it is **very turbulent**. Therefore, the local population does not bathe in the rainy months (usually from October to May, but it can be earlier or later) due to the danger it entails.

In the dry season, from June to September, beaches appear on the banks, and the local inhabitants take the opportunity to bathe in the river. If you choose to do so, do not forget that it is at **your own risk** and that despite the decrease in flow, it is still a powerful river. You must always be attentive and not stray from the shore. **Pumarinri Lodge does not have an aid or rescue service in the river and does not assume any responsibility in case of mishaps or accidents.**



SAFETY ON BOAT TOURS

During the boat tours on the Huallaga and Mayo rivers, we must comply with a series of **safety regulations**, mainly:

- . The use of a life jacket is mandatory from the time you get on the boat until you leave it.
- . It is not permitted to access the boat in a state of drunkenness or intoxication.
- . It is imperative to follow the instructions of the motorist in charge of the boat at all times.

Children activities



CHILDREN ACTIVITIES

The Pumarinri is a space for contact and discovery of the jungle and the natural environment.

Every day we have activities designed for children and the not-so-young. The hotel reception schedules these activities.

Rooms →

Rooms



CHECK IN / CHECK OUT

Check-In – 03:00 p.m. Check Out – 01:00 p.m.

After 1:00 p.m., the **Late Check Out** rate will be charged if the room is still occupied. The **full rate** will be charged if the room is still occupied at 4:00 p.m.

Even so, the Pumarinri reserves the right to **remove items** from the room if other guests need to occupy it.

DAY USE AND LATE CHECK OUT

The Day Use rate is equivalent to 50% of the room rate, and its use is from 9 a.m. to 4 p.m.

The Late Check-Out rate until 6:00 p.m. is equivalent to 50% of the room rate.



MINIBAR

The rooms have a minibar with drinks and snacks for sale.



SAFE BOX

Pumarinri Lodge **is not responsible for the disappearance or removal of money, jewellery or valuables** in the rooms. The rooms have a **safe box** with a security key. At the reception, we also provide custody service for goods.

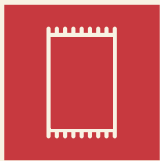

POOL TOWELS

For hygienic reasons, white room towels cannot be used in the lodge pools. However, at the reception, we will provide you with **towels for specific use in the pool.**

Neither the room towels nor the pool towels can be used outside the hotel (in the river, the falls or the lagoon).



UMBRELLA

Each room has an umbrella for exclusive use within the hotel. In case of loss or breakage, its replacement cost is S/ 100.



NO SMOKING

All rooms are **non-smoking**, as are the restaurant and public areas of the hotel.

If it is detected that smoking has occurred in the room, a **penalty of S/ 300** will be charged for deodorization and cleaning.

Sustainable use of resources



TOURCERT CERTIFICATION

At Pumarinri Amazon Lodge, we are proud to have the seal of the **German certifying company TourCert, which demonstrates our good practices** in environmental sustainability and social responsibility.



TOWELS AND SHEETS

With a rational use of towels, we save water, detergent and energy. Towels on the floor will be changed; if you hang them on the towel rails, they are to be reused.

If you want a change of sheets, please request it at reception.



PAPER IN THE TOILET

The Lodge has a biogester system for the treatment of sewage. The system is affected and could crash if we flush products like towels, papers, sanitary napkins or any item destined to personal use.



DRINKING WATER

We make the water we collect from a natural spring drinkable through a four-stage reverse osmosis filter. This water is used for cooking, making ice, juices and drinks and in the restaurant's water dispensers (natural or flavoured).



SINGLE-USE PLASTICS AND OTHER DISPOSABLES

We have minimized single-use plastics. For example, in the rooms' bathrooms, we have replaced the plastic bottles of shampoo and soap with refillable dispensers.

We have replaced the styrofoam disposable containers with biodegradable or reusable materials.



RATIONAL CONSUMPTION OF ELECTRICAL ENERGY

Ceiling fans produce a very pleasant and refreshing air circulation in the room, but if you leave them on while we are away, you will not find the room cooler when we return. We are only going to consume more energy.

Nor does it make sense to leave the lights on as that is an unjustified energy expenditure and adds the attraction of nocturnal insects to the rooms.



COLLECTION OF PLANTS AND ANIMALS

In the Pumarinri, Amazonian biodiversity is shown to us in all its splendour. Our best thanks



[PUMARINRI.COM](https://www.pumarinri.com)



If you do not want to take it away,
deposit it in the reception baskets
for reuse.